

Did you know you have SOLIDWORKS CAM

Automating CNC Programming with SOLIDWORKS CAM



Visit **Booth 412** to watch a short demo of SOLIDWORKS CAM and receive a **FREE T-Shirt**

SOLIDWORKS CAM is an integrated 2.5 & 3 axis CNC milling and 2 axis CNC lathe programming solution powered by CAMWorks.

By utilizing the emerging technologies of Model Based Definition (MBD) and Knowledge Based Machining, SOLIDWORKS CAM can rapidly transform your design-to-manufacturing process by improving communication, reducing errors, reducing cycle times, and increasing your product quality.

CAMWorks is the only CAM system that is 100% compatible with SOLIDWORKS CAM!

Where can I find SOLIDWORKS CAM in SOLIDWORKS?

Every seat of SOLIDWORKS 2018 and later currently on subscription, includes SOLIDWORKS CAM Standard
You can find SOLIDWORKS CAM under Add-ins

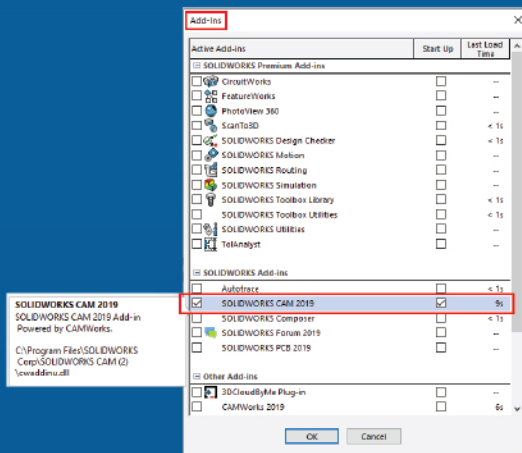

Which SOLIDWORKS CAM Package is right for you?

SOLIDWORKS CAM Standard includes programming for individual 2.5 & 3 Axis Milling parts and includes Tolerance-Based Machining (TBM)

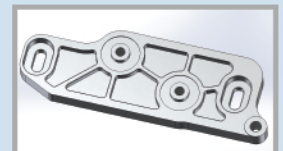

SOLIDWORKS CAM Professional builds on the capabilities of SOLIDWORKS CAM Standard to increase programming capabilities. SOLIDWORKS CAM Professional adds: Assembly Machining, Turning, 3+2 Milling, High-Speed Machining, and support for multiple SOLIDWORKS CAM configurations

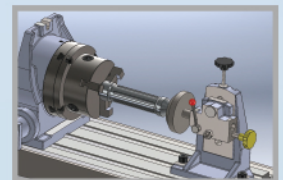

Where Can I Get Post Processors?

Post processors are a critical part of any CAM system. Their basic function is to translate the toolpath you see on screen to machine-readable code (G-code), but with the right post processor you can reduce machine cycle time, remove manual editing and provide more information to your operators for a faster setup time

Here is the link for our post processor library -
<https://camworks.com/post-processor-library/>

Where Can I Access SOLIDWORKS CAM Trainings & Webinars?

CAMWorks team conducts SOLIDWORKS CAM trainings and webinars every quarter. You can register for webinars on below link

<https://camworks.com/new-events/webinar-learn-solidworks-cam-today/>

You can also reach out to your local SOLIDWORKS reseller and
<https://www.solidprofessor.com/>

SOLIDWORKS CAM BENEFITS

Reduce Programing Time

- Simplifies collaboration - single design and programming environment allows easier transition to CAM
- Rules-based machining allows companies to capture their best practices
- Feature-based intelligent machining

Improve Quality

- Automatically updates toolpaths to design changes
- Utilizes concurrent development process - allowing companies to perform tasks sooner, find problems earlier, and reduce rework and scrap

Faster Cycle Times

- Reduce cycle time up to 80%
- Increase tool life up to 500%
- Often doubles machining capacity

Tolerance Based Machining

- Reads SOLIDWORKS MBD/DimXpert dimensions and surface finishes
- Automatically selects machining strategies to meet the specified tolerances

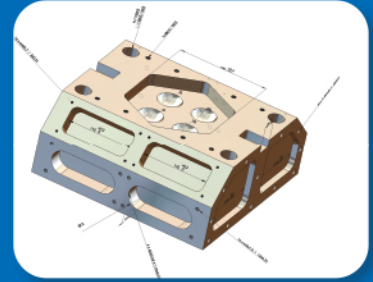
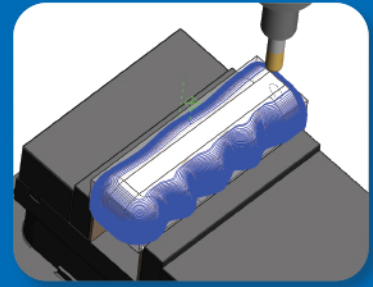

| Function | SOLIDWORKS CAM Standard | SOLIDWORKS CAM Professional | CAMWorks Standard | CAMWorks Milling Standard | CAMWorks Turning Standard | CAMWorks Milling Professional | CAMWorks Turning Professional | CAMWorks Premium | CAMWorks Bundle Add-Ons |
|---|-------------------------|-----------------------------|-------------------|---------------------------|---------------------------|-------------------------------|-------------------------------|------------------|-------------------------|
| 2.5 Axis Milling Plus* | ✓ | ✓ | ✓ | ✓ | ✓ | ✓ | ✓ | ✓ | |
| Cimco Editor/DNC | ✓ | ✓ | ✓ | ✓ | ✓ | ✓ | ✓ | ✓ | |
| 2.5 Axis VoluMill | | ✓ | ✓ | ✓ | ✓ | ✓ | ✓ | ✓ | |
| Probing | | ✓ | ✓ | ✓ | ✓ | ✓ | ✓ | ✓ | |
| 3 Axis Milling - L1* | | ✓ | ✓ | ✓ | ✓ | ✓ | ✓ | ✓ | |
| 4/5 Axis Indexing | | ✓ | ✓ | ✓ | ✓ | ✓ | ✓ | ✓ | |
| Turning | | ✓ | ✓ | ✓ | ✓ | ✓ | ✓ | ✓ | |
| Sub-Spindle | | | ✓ | ✓ | ✓ | ✓ | ✓ | ✓ | |
| Rotary Milling | | | ✓ | ✓ | ✓ | ✓ | ✓ | ✓ | |
| 3 Axis Milling - L2* | | | | ✓ | | ✓ | | ✓ | |
| Mill-Turn | | | | | ✓ | ✓ | ✓ | ✓ | |
| 3 Axis Milling - L3* | | | | | | ✓ | | ✓ | |
| Synchronous Machining for Lathes | | | | | | | ✓ | ✓ | ✓ |
| Virtual Machine Standard | | | | | | | ✓ | ✓ | ✓ |
| 4 Axis Milling (Add-On to Milling Pro only) | | | | | | | | ✓ | ✓ |
| 5 Axis Simultaneous | | | | | | | | ✓ | |

Products available as Bundle Add On

3 Axis VoluMill
Virtual Machine Professional
Virtual Machine Premium
PrimeTurning™
CAMWorks Utilities

Additional Product Options

Wire EDM
NestingWorks
CAMWorks ShopFloor

- * 2.5 Axis Milling Plus includes 2.5 Axis Milling plus Area Clear Roughing, Flat Area and Z-Level Finishing
- * 3 Axis Milling L1 includes all of the above plus a Z-Level Finishing combined cycle for steep/shallow machining
- * 3 Axis Milling L2 Includes all L1 functionality plus Pattern Project, Constant Step, Pencil Milling, 3 Axis Rest Machining, Curve Project, and Legacy Rough & Finish Mill
- * 3 Axis Milling L3 Includes L2 functionality plus Multi-Axis Operations including Undercutting, Fillet Machining, and NURB Surface Machining

PrimeTurning™ is a Sandvik Coromant product.



About CAMWorks:

CAMWorks is an intuitive CAM software combining production-proven feature based CAM technology, automatic feature recognition, and rules based machining along with tolerance based machining to leverage MBD and PMI technology to automate Smart Manufacturing for CNC programming - paving the way to advanced digital manufacturing.

For more details, please visit www.camworks.com or contact camworks.inquiries@hcl.com